

**DISTINCTIVE DESIGNS  
OUTSTANDING PERFORMANCE**

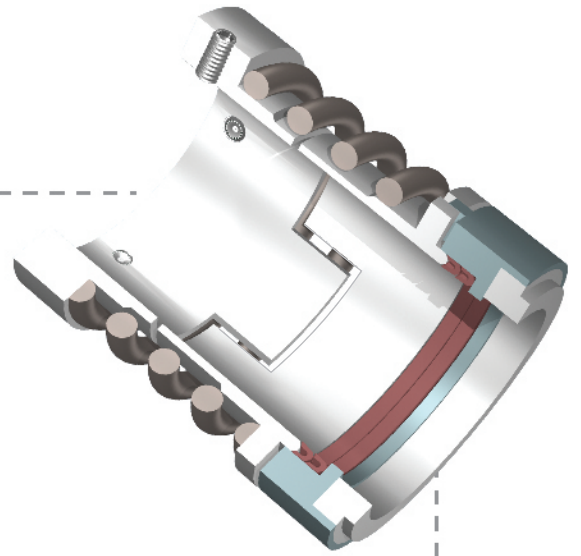

## SINGLE SPRING SEAL

- STURDY & RUGGED DESIGN
- RELIABLE PERFORMANCE
- BI-DIRECTIONAL POSITIVE DRIVE
- FITS ANSI, ISO & DIN PUMPS
- METRIC SIZES CONFIRM TO EN12756 -  $\ell 1N$
- EASY TO INSTALL

## APPLICATIONS

- VISCOUS & ARDUOUS DUTIES
- CRYSTALLIZING & SOLIDIFYING MEDIA
- ABRASIVE SLURRIES UPTO MODERATE CONCENTRATIONS
- HEAT TRANSFER LIQUIDS UPTO MODERATE TEMPERATURES

