

## Process Gauges

### Size Availability:

inches	mm
4.5"	115



**Connection:** Bottom (Surface Mount)  
Back (Lower Back Mount)

### Typical Applications



: Gauge with Heavy Duty construction and superior performance against tough and corrosive applications in industries, process, power, nuclear and cryogenics. Thermoplastic (PBTP 20%) gives longer life to the pressure gauge under adverse operating conditions.

## Standard Features

**Nominal Sizes:**  
115mm

**Scale Ranges:**  
Pressure from 0...1.0 to 0...1000kg/cm<sup>2</sup>

**Accuracy Class:**  
±1.0% of FSD

**Pressure Connection:** Bottom/Back  
1/4", 1/2", 3/8" BSP / NPT

**Mounting:**  
Bottom Direct, Surface Mount,  
Lower Back Direct

**Liquid Filling:** Dry

**Over-Range Protection:** 130% of FSD

**Enclosure Protection:** IP 65

**Special Versions / Optional / Extras:**  
Special Liquid Filling

**Bourdon Tube (Wetted Part) Material:**  
Copper Alloy / SS 316

**Pointer:** Alluminium  
Micrometer Zero Adjust

**Movement Material:**  
Copper Alloy / SS 304

**Pressure Element:**  
Material: Copper Alloy / SS 316  
< 100kg/cm<sup>2</sup>: C-type  
> 100kg/cm<sup>2</sup>: Coil type

**Window:**  
Toughened / Safety Glass

**Case Material:**  
Black Phenol Case

**Bezel Ring:**  
Screwed

**Dial:**  
White Aluminium with Black Marking

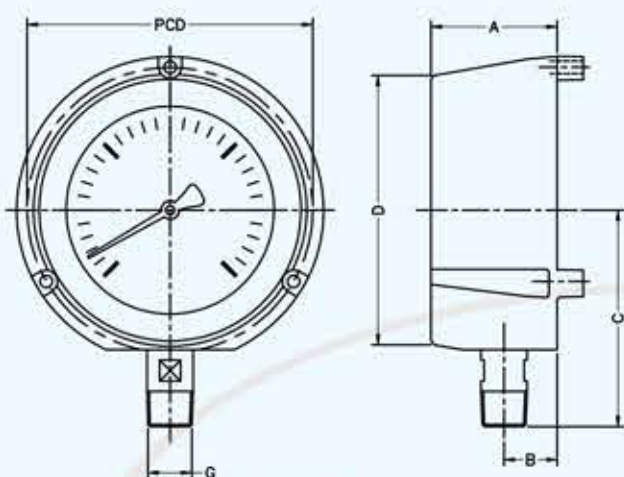

**BOTTOM CONNECTION**

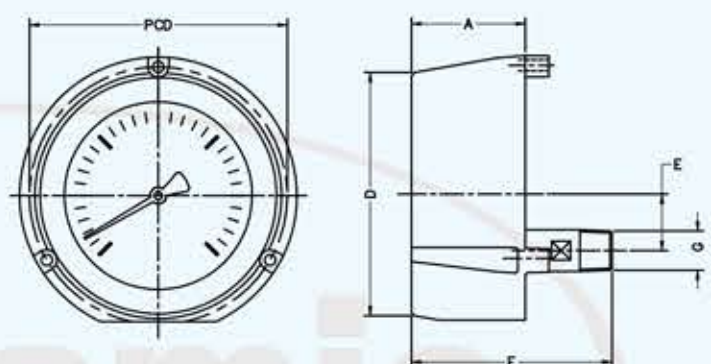

**BACK CONNECTION**

### PROCESS GAUGE STANDARD DIMENSIONS

NOMINAL SIZE	A	B	C ±1	D	PCD	E	F ±1	G
114 MM	60.5	25.4	104.0	129.0	137.0	30.0	106.5	1/2"