

// Tested to BS 476, LPS, Part 22: 1987, Approved to 1056



Steel Fire Doors to British Standard

Single and double-leaf doors in matching appearance
with additional protection features





Hörmann fire protection

Because it's good to be on the safe side

In-house product development

Pre-tested in Hörmann's own fire house

200,000 times in the fatigue test

State-of-the-art production



Reliable fire protection calls for adequate new developments and improvements in each and every detail. This is where our qualified development teams demonstrate their competence time and again. Hörmann has continually extended its fire protection programme. Today, as a result, we can offer a complete and fully developed range.



In our own lab's fire house, highly sensitive instruments precisely measure the thermal load. In this way, new developments can be tested at every stage and optimum conditions created for external testing and the granting of official approvals.



Alongside heat resistance, mechanical serviceability is an essential constituent of the extensive material testing carried out. This ensures that over many years in daily use Hörmann doors will always function to perfection.

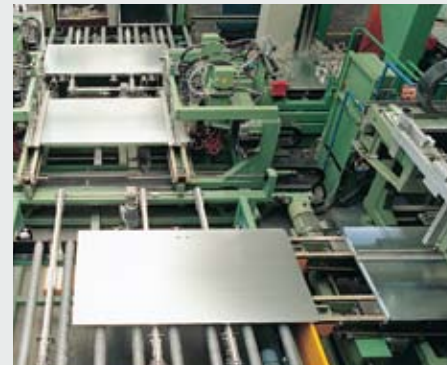

Hörmann invests in modern production technology in highly-specialized factories. Computer-controlled processing guarantees precision cutting and the perfect fit of all hardware and functional components. This is the prerequisite for customized solutions in the non-domestic building sector.



Purchase Hörmann fire doors and you are assured quality, protection and safety for decades. Take advantage of our comprehensive range to meet the special requirements of your application in the non-domestic building sector.

Assured quality

Expert fitting

Competent advice and support

A highly skilled workforce



Despite the high degree of computer-controlled production processes, Hörmann does not underestimate the value of its skilled and highly responsible workforce. Particularly when specific solutions are called for. But also throughout the production process, quality controls and in the logistics sector, a great deal depends on the performance of qualified specialist personnel.



In-house checks and external monitoring safeguard the recognized high quality standard, in the case of fire doors in accordance to the regulations, for smoke-tight doors in keeping our own self-imposed high standards and sense of responsibility.



Experienced specialist advisors from our customer-oriented sales organization accompany you throughout all the various stages of your project - from planning, through technical clarification to final inspection. Complete working documentation is not only available in printed form but is also continually updated on the Internet at **www.hoermann.com**



Where preventive fire protection is concerned, expert fitting is just as important as the high quality of the product itself. Experienced Hörmann fitters and the trained specialist personnel of our business partners ensure that the doors are always fitted properly.



Tested to B.S. 476:
part 22: 1987 by the
Loss Prevention Council.

HBS 30 A-1 HBS 60 A-1

Fire Door fire-retardant

Ideal for Domestic, industrial & commercial buildings, Basement, Storage, Agriculture, Fire sections, fire walls



BS 476 part 22:1987
and LPS 1056

HBS 30 Assessment report number CC 229620

HBS 60 Assessment report number CC 229618

Standard Equipment

Door leaf	45 mm thick Rebated on 2 sides Sheet thickness 0.9 mm Thermal insulation: mineral wool board 2 steel security bolts on the hinge side Intumescent seal
Frame	Special corner frame with all-round sealing (on 4 sides) Counter frame for wall thickness MW 110 to 330 mm Block frame in the reveal with 6 fixing points per side Aluminium threshold profile with seal
Surface finish	Door leaf and corner frame galvanized and primed in RAL 9002 grey white Block frame in the reveal galvanized and primed in RAL 7035 light grey
Hinges	Spring hinge Hinge to DIN 18272
Fittings	Mortice lock with lever/knob - prepared for profile cylindre FS round lever handle set with lever securely fitted Panic bar handle

Product

Benefits:

- Acoustic-rated, guide value P approx. 39 dB (corner frame)
- Thermally insulated $U = 1.7 \text{ W/m}^2\text{K}$ (corner frame)
- Dual-handed (corner frame)
- All-round sealing (corner frame)
- 2 steel bolts to prevent door from being levered open

Accessories:

- Available for finished floor
- Door leaf in chosen RAL colour
- Frame in chosen RAL colour
- Door set with counter frame
- Aluminium threshold with seal
- Bar handle BKS black with knob
- Bar handle BKS black with lever

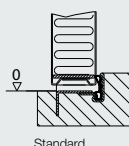

Standard floor rail



Dual-handed with corner frame

You determine the handing on site - LH or RH hinging.
You simply turn the doors round. No need to remove and relocate bolts - the quick fitting method!

Fire Door fire-retardant



BS 476 part 22:1987 and
LPS 1056



Corner Frame

Standard sizes

Structural opening (ordering size) width x height	Clear passage width x height
800 x 2000	722 x 1961
800 x 2100	722 x 2061
900 x 2000	822 x 1961
900 x 2100	822 x 2061
1000 x 2000	922 x 1961
1000 x 2100	922 x 2061

Special sizes

Structural opening
Width: 635 - 1155
Height: 1755 - 2139

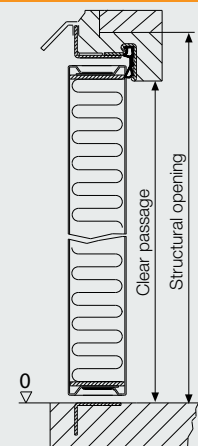
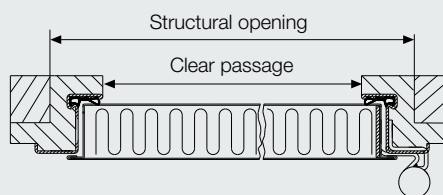

Reveal Frame

Standard sizes

Structural opening (ordering size) width x height	Clear passage width x height
800 x 2000	660 x 1930
800 x 2100	660 x 2030
900 x 2000	760 x 1930
900 x 2100	760 x 2030
1000 x 2000	860 x 1930
1000 x 2100	860 x 2030

Special sizes

Structural opening
Width: 697 - 1217
Height: 1786 - 2170

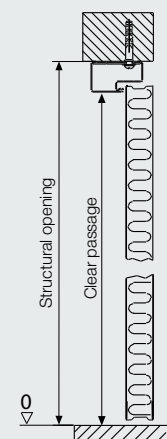
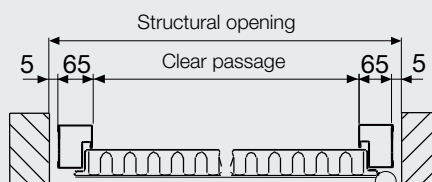





Fire Door fire-retardant



tested to BS 476 part 22:1987
approved to LPS 1056

Standard equipment

Door leaves	55 mm thick Sheet thickness 1.0 mm	Hinges	3-piece construction hinges on ball bearings
Rebate	To 3 sides Thin rebate or thick rebate	Closing devices	Spring hinge
	 	Security bolts	1 steel bolt (over a height of 2000 mm 2 bolts)
Frame	System corner frame 2.0 mm thick, 30 mm floor recess Chloroprene sealing profile Welded-on grouting lugs/anchor brackets	Fitting into	<ul style="list-style-type: none"> • masonry at least 175 mm • concrete at least 140 mm • partition walls 150 mm • gas concrete (stone slabs or concrete precision blocks) Strength class G4-GP4 at least 175 mm thick
Surface	Door leaf and frame galvanized and powder-coated with a primer in off-white (based on RAL 9002).		Gas concrete as reinforced slabs Strength class G4 at least 175 mm thick
Lock	Mortise lock with lever/knob DIN 18250 prepared for profile cylinder Deadlock insert with key		
Handle set	Fire-proof round handle/lever handle set in aluminium F1 (lever handle pivoted on bearing) with short escutcheons can be used for profile cylinder and deadlock key		



Fire Door fire-retardant



tested to BS 476 part 22:1987
approved to LPS 1056

Standard sizes

Type	Structural opening* (ordering size) width x height
HBS 60 C-1	1000 x 2000
	1000 x 2100
	1100 x 2100
	1200 x 2100
	1100 x 2200
	1100 x 2500
	1250 x 2500
HBS 120 C-1	1000 x 2000
	1000 x 2100
	1100 x 2100
	1150 x 2100
	1150 x 2200
	1150 x 2500

Glazing

Type	Window size (figure 1) width x height
HBS 60 C-1	140 x 815
	140 x 815
	140 x 815
	140 x 815
	140 x 815
	140 x 815
	140 x 815
HBS 120 C-1	140 x 815
	140 x 815
	140 x 815
	140 x 815
	140 x 815
	140 x 815

Size range

Structural opening*

HBS 60 C-1

Width 635 - 1260 mm

Height 1755 - 2505 mm

Ceiling-high

Max. height 3505 mm

HBS 120 C-1

Width 635 - 1260 mm

Height 1755 - 2505 mm

max. 2.95 m²

When ordering, please specify LH or RH hinging.



LH hinged

RH hinged

Special glazing

max. 50% of the door area

HBS 120 C-1

max. 0.34 m²

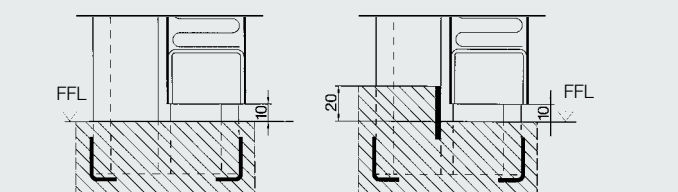

Door floor detail
for flat floor
as standard

Door floor detail
with stepped threshold,
on request or on site



Fire Door fire-retardant



tested to BS 476 part 22:1987
approved to LPS 1056

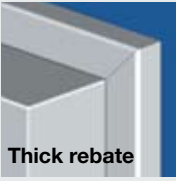

Standard equipment

Door leaves	55 mm thick Sheet thickness 1.0 mm	Handle set	Fire-proof round handle/lever handle set in aluminium F1 (lever handle pivoted on bearing) with short escutcheons can be used for profile cylinder and deadlock key
Rebate	To 3 sides Thin rebate or thick rebate	Hinges	3-piece construction hinges on ball bearings
	 Thin rebate  Thick rebate	Closing devices	HBS 60 C-2: 2 spring hinges with separate leaf selector HBS 120 C-2: Overhead door closer with lifting arm TS 4000 with separate leaf selector
Frame	System corner frame, 2.0 mm thick 30 mm floor recess Chloroprene sealing profile Welded-on grouting lugs/anchor brackets	Security bolts	1 steel bolt per leaf (over a height of 2000 mm 2 bolts)
Surface	Door leaf galvanized and powder-coated with a primer in off-white (based on RAL 9002). System corner frame galvanized and powder-coated with a primer in off-white (based on RAL 9002).	Fitting into	<ul style="list-style-type: none"> masonry at least 175 mm concrete at least 140 mm partition walls 150 mm gas concrete (stone slabs or concrete precision blocks) Strength class G4-GP4 at least 175 mm thick Gas concrete as reinforced slabs Strength class G4 at least 175 mm thick
Lock	Mortise lock with lever/knob DIN 18250 prepared for profile cylinder Deadlock insert with key Fixed leaf with espagnolette lock in rebate (locking to top and bottom)		

HBS 60 C-2 HBS 120 C-2

Fire Door fire-retardant



tested to BS 476 part 22:1987
approved to LPS 1056



Standard sizes

Type	Structural opening* (ordering size) width x height
HBS 60 C-2	1600 x 2000
	1600 x 2100
	1600 x 2300
	1800 x 2000
	1800 x 2100
	1800 x 2300
	2000 x 2000
	2000 x 2100
	2000 x 2300
	2200 x 2100
	2400 x 2300
	2500 x 2500
HBS 120 C-2	1600 x 2000
	1600 x 2100
	1600 x 2300
	1800 x 2000
	1800 x 2100
	1800 x 2300
	2000 x 2000
	2000 x 2100
	2000 x 2300
	2300 x 2300
	2300 x 2500

Glazing

Type	Window size (figure 1) width x height
HBS 60 C-2	140 x 815
	140 x 815
	140 x 815
	140 x 815
	140 x 815
	140 x 815
	140 x 815
	140 x 815
	140 x 815
	140 x 815
	140 x 815
HBS 120 C-2	140 x 815
	140 x 815
	140 x 815
	140 x 815
	140 x 815
	140 x 815
	140 x 815
	140 x 815
	140 x 815
	140 x 815
	140 x 815

Special glazing

max. 50% of the door area

HBS 120 C-2
max. 0.34 m²

Size range

Structural opening*

HBS 60 C-2

Width 1385 - 2510 mm

Height 1755 - 2505 mm

Ceiling-high

Max. height 3505 mm

Unequal door leaf widths possible.

Traffic leaf:

Width min. 750 mm

max. 1250 mm

Fixed leaf:

Width min. 500 mm

max. 1250 mm

When ordering, please specify LH or RH hinging.



Traffic leaf LH hinged

Traffic leaf RH hinged

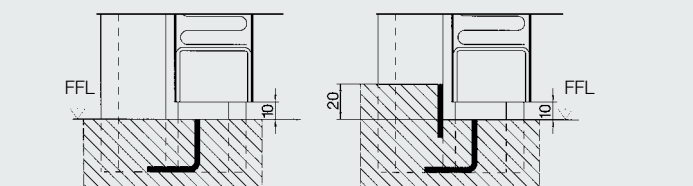

Floor detail of door
for flat floor
as standard

Floor detail of door
with stepped threshold,
on request or on site

Frame Types and Fitting Situations

Fire Doors HBS 30 A-1 and HBS 60 A-1	
Frame type	Fitting situation

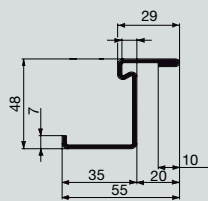

Corner frame

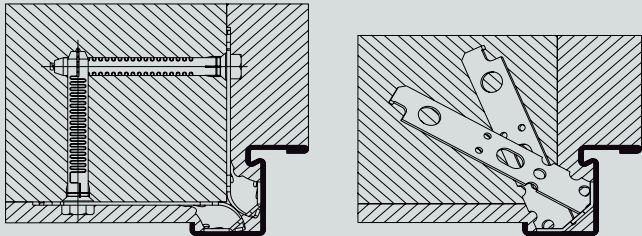

Fitting into masonry grouting lugs/anchor brackets

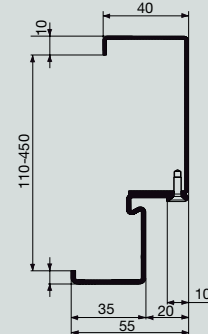

Corner frame with counter frame

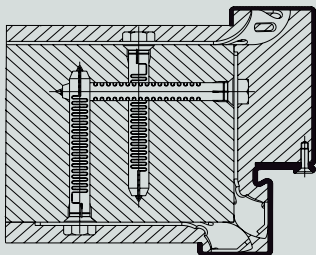

Fitting into masonry grouting lugs/anchor brackets

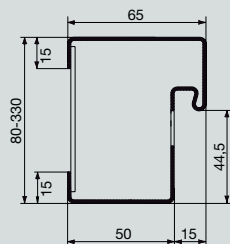

Block frame type 1

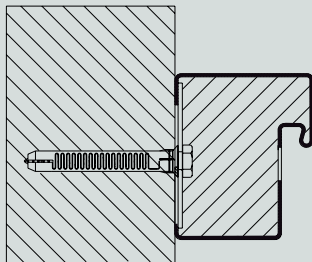

Fitting in the opening

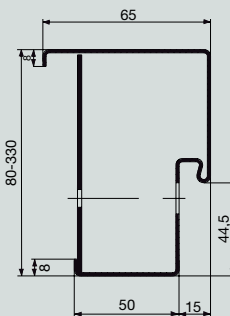

Block frame type 2

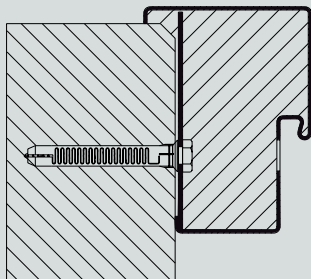

Fitting in the opening

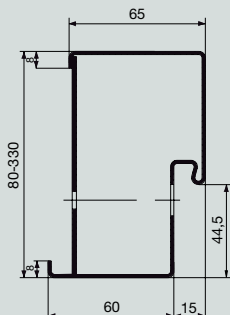

Block frame type 3

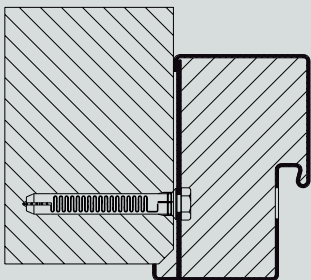

Fitting in the opening

Frame Types and Fitting Situations



Fire Doors HBS 60 C-1, HBS 120 C-1, HBS 60 C-2 and HBS 120 C-2

Frame type

Fitting situation

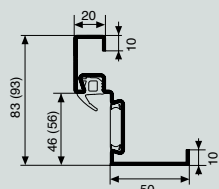

Corner frame

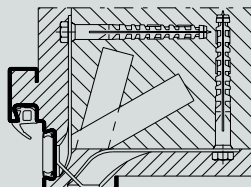

Fitting to brickwork
Anchor bracket for brickwork

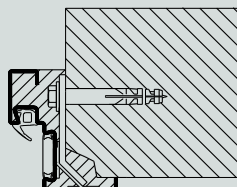

Fitting to unplastered brickwork
or concrete with anchor brackets

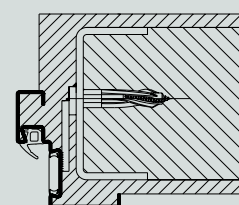

Fitting to gas concrete

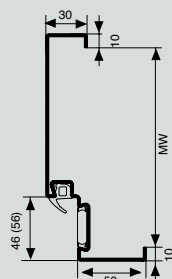

Profile frame

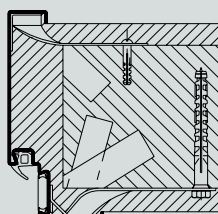

Fitting to brickwork
Anchor bracket for brickwork

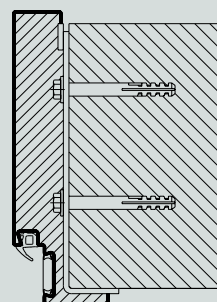

Fitting to unplastered brickwork
or concrete

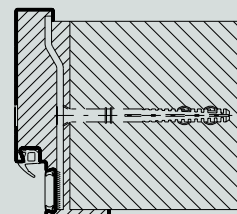

Fitting to unplastered brickwork
or concrete

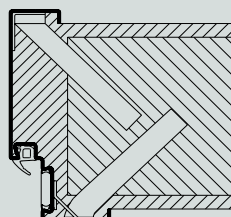

Fitting to gas concrete

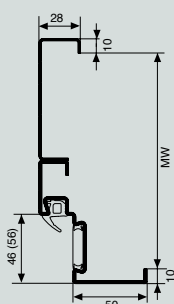

Corner frame with counter frame

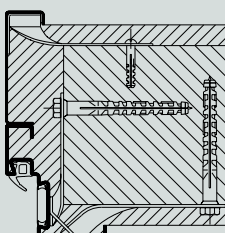

Fitting to brickwork
Anchor bracket for brickwork

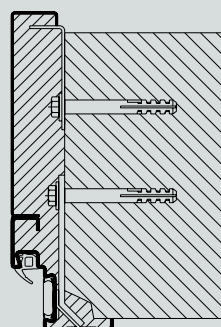

Fitting to unplastered brickwork
or concrete

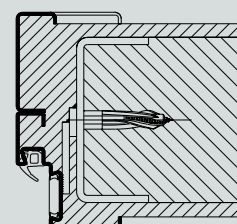

Fitting to gas concrete

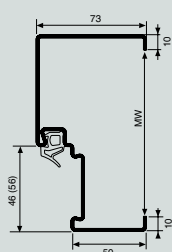

B 73 frame

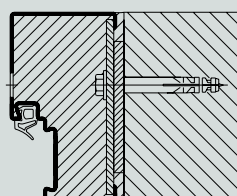

Fitting in the opening
Anchor bracket up to MW 205 mm

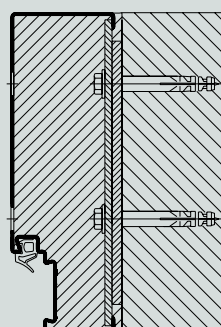

Fitting in the opening
Anchor bracket from MW 205 mm

Hörmann: Quality without Compromise



Hörmann KG Amshausen



Hörmann KG Antriebstechnik



Hörmann KG Brandis



Hörmann KG Brockhagen



Hörmann KG Dissen



Hörmann KG Eckelhausen



Hörmann KG Freisen



Hörmann KG Ichttershausen



Hörmann KG Werne



Hörmann Genk NV, Belgium



Hörmann Beijing, China



Hörmann Gadco LLC, Vonore TN, USA

Hörmann is the only manufacturer worldwide that offers you a complete range of all major building products from one source.

We manufacture in highly-specialized factories using the latest production technologies.

The close-meshed network of sales and service companies throughout Europe, and activities in the USA and China, make Hörmann your strong partner for first-class building products, offering "Quality without Compromise".

GARAGE DOORS

OPERATORS

INDUSTRIAL DOORS

LOADING EQUIPMENT

HINGED DOORS

DOOR FRAMES